

EARBUD FUNCTIONS

HOW TO USE

PAIRING TO YOUR DEVICE

Remove both earphones from the charging case. After a few seconds, the right earbud will begin to flash red and blue. Now on your device, go to the Bluetooth settings and select "DECIBULLZ".

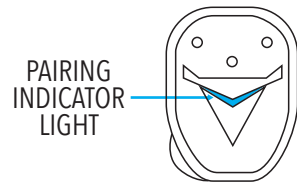

DIGITAL AWARENESS

These earphones come equipped with a Digital Awareness feature that allows you to hear your surroundings when you choose to. Simply quick double press the logo button on the left earphone to turn Digital Awareness On and Off.

90DB SAFETY FEATURE

To better protect you, these earphones have been equipped with a safety feature that automatically turns off Digital Awareness (if in use) when sounds above 90dB are detected. Digital Awareness will automatically turn back on when external sounds drop below 90dB.

MUSIC CONTROLS

- ▶ **Play** - Quick press logo button (L or R)
- || **Pause** - Quick double press logo button (R)
- (i) **Digital Awareness On and Off** - Quickly double press the logo (L)
- + **Volume** - Quick press logo button (R)
- **Volume** - Quick press logo button (L)
- ▶▶ **Skip Forward** - Long press (2 sec.) logo button (R)
- ◀◀ **Skip Backward** - Long press (2 sec.) logo button (L)

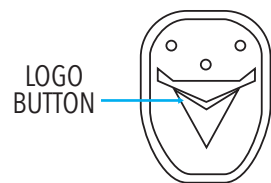

VOICE ASSISTANT & CALLING

- 🔊 **Voice Assistant** - Pause audio (if listening) and double quick press logo button (R)
- ☎ **Answer Call** - Quick press logo button (L or R).
- ✖ **Silence a Call** - Long press (2 sec.) logo button (L or R)

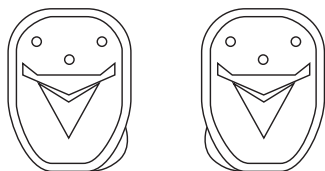

OTHER FUNCTIONS

Power On Without Charging Case
Long press logo button for 2 seconds (L and R)

Power Off Without Charging Case
Press and hold logo button for 5 seconds (L and R)

Case Battery Light
1 Flash for every 25% of battery remaining in the charging case.
Solid light for charging or charged.

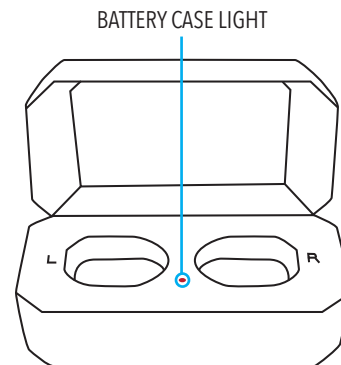

L and R Case Lights
The L and R lights will illuminate when the earphones are charging and will turn off when they are fully charged.

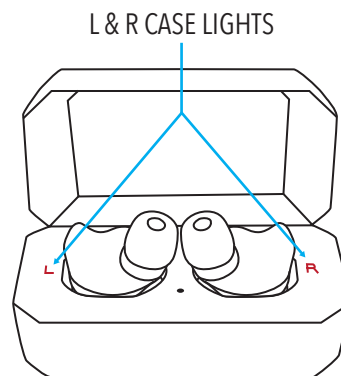

Earphone LED
Alternating red and blue lights means the earphones are in pairing mode.

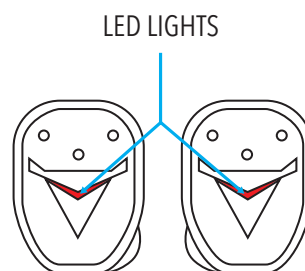

FOLLOW US

Join the Decibullz community on social media for the latest product news, special discounts and promotions.

USE #DECIBULLZ



DECIBULLZ



CUSTOM MOLDED TRUE WIRELESS EARPHONES

WARNINGS

The molding process involves heating your molds in very hot water and forming them to your ears. **DO NOT PLACE THE HOT MOLD INTO YOUR EAR!** Wait until the mold is warm and pliable. Do not leave your earphones or custom molds in your car or any other place that may expose them to temperatures above 120°F/49°C. The molds will melt and your earphones can become damaged.



CAUTION:
CHOKING HAZARD

Keep away from children. Parts are nontoxic but may interfere with breathing if caught in windpipe.

WHAT IS INCLUDED



Charging Case

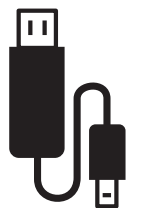

USB-C Charging Cable



Silicone Canal Tips (S,M,L)



Decibullz True Wireless Earphones (L&R)



Molding Tool

Decibullz Custom Molded Earpieces (L&R)

START HERE



For the best results, watch our instructional video at www.decibullz.com/truewireless

HOW TO MOLD

Please review these instructions first to familiarize yourself with the molding process.

YOU WILL NEED

A cup, bowl, or pan at least 4 inches deep with a flat base at least 3 inches in diameter and boiling water.

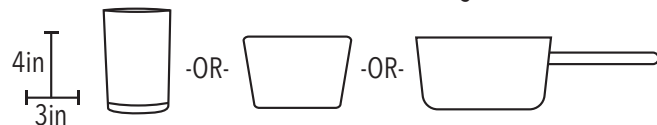

STEP 1

Charge the case and earphones

Place the earphones into the charging case and fully charge earphones and charging case before setting up. The left earphone will only charge in the left cavity and vice versa. The "L" & "R" on the charging case will light up while the earphones are charging. If the Custom Molded Earpieces are attached to the earphones remove them at this time.

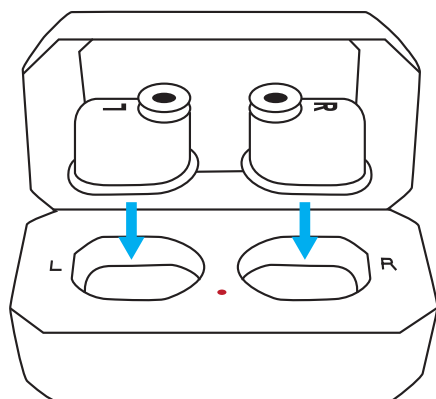
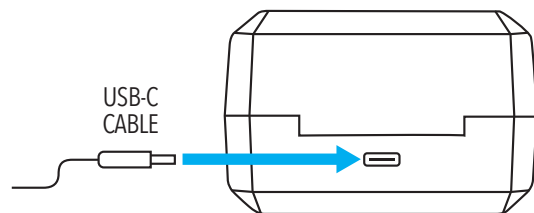

STEP 2

Select silicone tip size

Choose the silicone tips that will fit you best and securely place them onto the custom earpieces. Check to make sure the silicone tips are securely attached. ONLY PLACE THE CUSTOM MOLDS AND THE MOLDING TOOL INTO THE WATER. DO NOT PLACE EARPHONES INTO THE WATER!

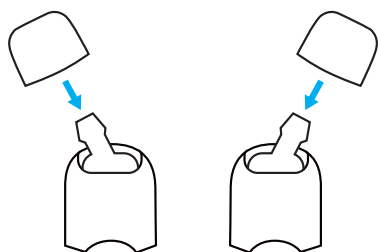

STEP 3

Place custom molds on molding tool

Assemble molding tool as shown. Test the molding tool to make sure it fits into your container and sits flat on the base.

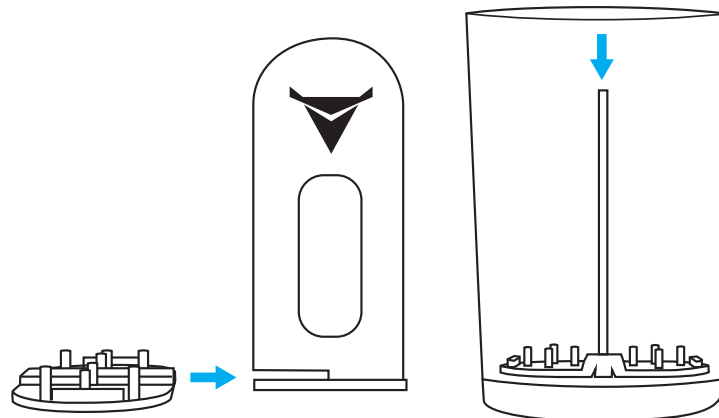

Place custom molds on the molding tool making sure the left and right earpieces are on the left and right side of the molding tool.

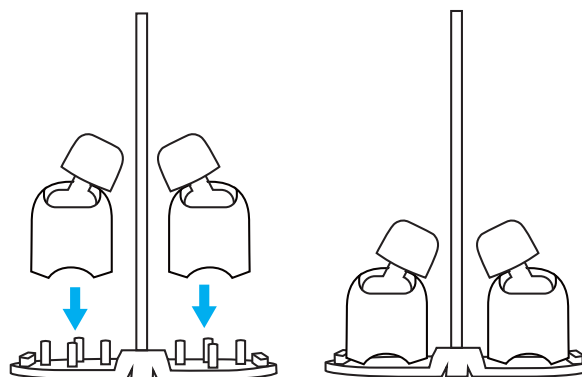

STEP 4

Heat water to a boil

Stovetop: Boil 3in of water and remove from heat source. Kettle or Microwave: Fill a container with 3in of boiling water. Slowly insert the molding tool and earpieces into the hot water and let sit for 5 minutes.

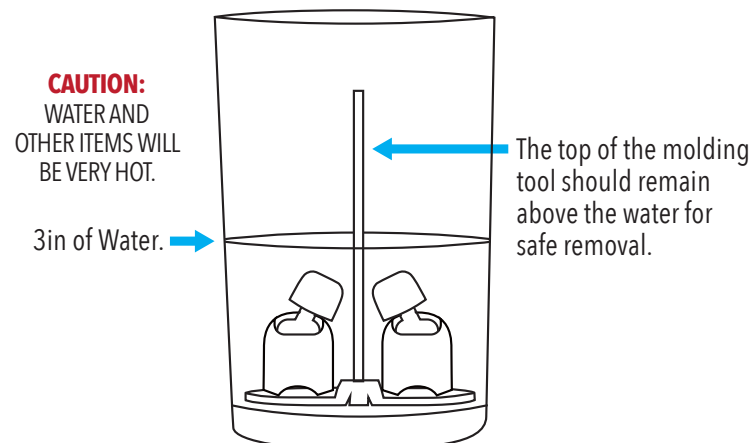

STEP 5

Preparing to mold the earpieces

Carefully remove the molding tool and molds from the hot water and remove one of the custom molds. Place the tool and remaining earpiece back in the water. Wait 30 seconds for the earpiece, that you have just removed from the molding tool, to cool.

TIP Using a mirror can make the process easier.

STEP 6

Molding the earpieces

Be sure the "R" custom mold goes in your right ear. The silicone tip should be towards the bottom. Now firmly press the earpiece into your ear. You may need to press and smooth the molding material slightly for a cleaner appearance. Immediately repeat the process for the other ear with the remaining mold. Leave the earpieces in your ear for 4 minutes to cool. Repeat the process for the other ear.

CAUTION: DO NOT PLACE THE MOLD INTO EAR WHILE IT IS HOT! WAIT UNTIL THE MOLD IS WARM AND PLIABLE.

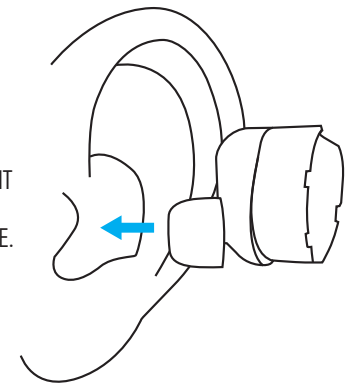

Note: You will not feel an acoustic seal until the earphones are inserted in the next step.

STEP 7

Snap in the earphones

Once the earpieces have cooled for 4 minutes, remove them from your ears and snap in the earphones. Make sure the right earphone goes into the right earpiece and the left earphone goes into the left earpiece.

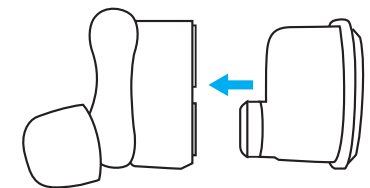

Place both earphones back into the charging case and follow pairing and use instructions on the next page.

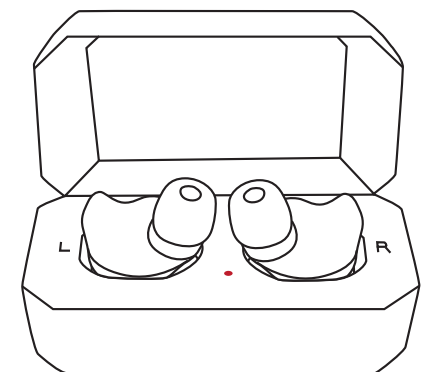

REMOLDING

If you do not feel an acoustic seal after molding try various sizes and combinations of canal tips before re-molding. If for any reason you would like to re-shape your earpieces simply unsnap the earphones from the custom molds by using the notches to gently release the earphones. Then repeat steps 2-6.

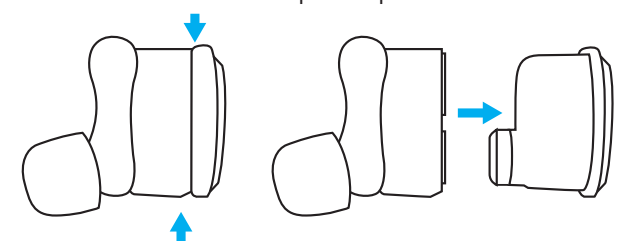

To separate the custom mold from the earphone, place your thumb and finger on the notches at the top and bottom of the earphone and gently pull.